

# N300812-A SmartDrape™

## Installation Instructions

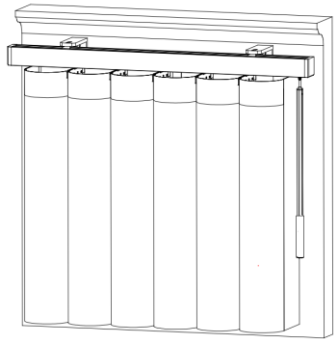

SmartDrape™

### Required Tools

- Drill
- Measuring Tape
- Screwdriver
- Level
- Pencil
- Hexagon Socket



### Components

Name	Drawing	Outside Mount	Ceiling Pocket Mount
L Bracket	Not for ceiling pocket mount	✓	
Spacer (shim)	Optional for outside mount only	✓ (optional only)	
C Clip		✓	✓
Nut		✓	
Bolt		✓	
Hex Head Screw	For installing L bracket	✓	
Flat Head Screw	For installing spacer in ceiling pocket		✓
Mushroom head Screw	For ceiling pocket mount only		✓

### Positioning

#### Outside Mount

- Tighten the nut and bolt after the C clip has been adjusted to the needed position on the L bracket. Adjust the C clip to the needed position then tighten the nut

- See below bracket position chart for "X".

R ≤ 40"	X=4"
40" < R ≤ 65"	X=10"
R > 65"	X=15"

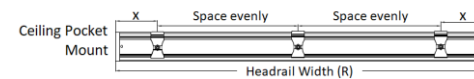
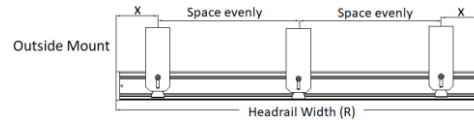

- Make sure that the distance from the top of the bracket to the edge of the window frame is at least 3" (see below).



- Place brackets into position and mark where the screws will go. Secure the brackets into position using the hex head screws provided. If more brackets have been supplied, space them evenly between the first two brackets. We recommend using a level to align brackets.

#### Ceiling Pocket Mount

- For Ceiling pocket mount, the distance from the middle of the headrail to the wall should be at least around 3 3/8"

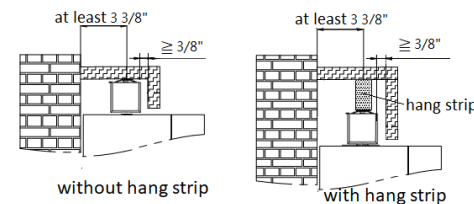

### Installation

#### Install the headrail

Position the top front lip of the headrail into the C clip front lip, then push the headrail up at the back to click it into place as per step 2 in diagram below.

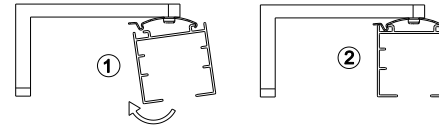

For side by side shades, add a C clip where the two headrails meet.

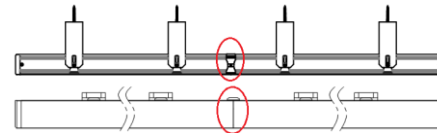

#### Install the fabric vanes

- Unroll the fabric. Take the fabric vanes one by one from the top of the unrolled fabric. If there are two rolls, start with roll A.
- The first vane on the top (from the top of the unrolled fabric) goes to the left end.
- Fasten the fabric vanes to one another by clasping the male and female clips together, as per step 1 in the diagram below. Then push the clips up to the carriers, as per step 2&3 in the diagram.

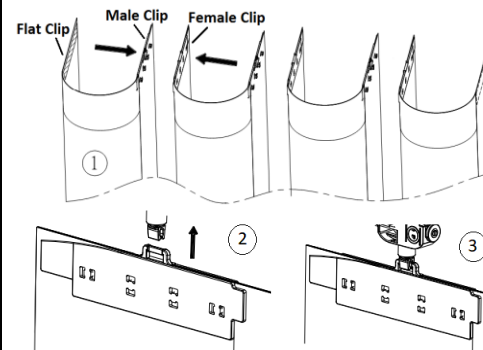

- Assemble the fabric vanes from the left to right. Repeat the above step and then done.

### Removal

- **Remove the fabric vanes**  
Pull down the fabric clips from the carriers; then detach the male and female clips holding the fabric together.

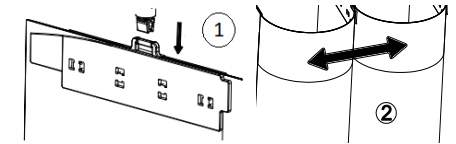

- **Remove the headrail**  
Insert flat screwdriver between the c clip and the headrail at the back. Tilt screwdriver forward until headrail loosens. Remove headrail from clip.

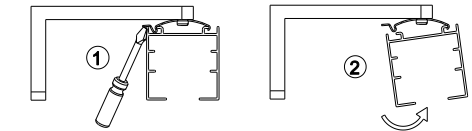

### Steaming

- Fabric vane can be steamed set at "Nylon" (around 200-220°F).
- It's recommended that you save the paper tube that came with the fabric roll and place it behind the fabric vane while steaming.

N300812-A

## SmartDrape™

### Operation Instructions

- To operate, just rotate the wand to let in the light or to keep privacy.

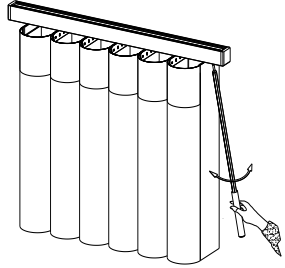

- Make sure the fabric vanes are in open position when stacking the shade open or closed.

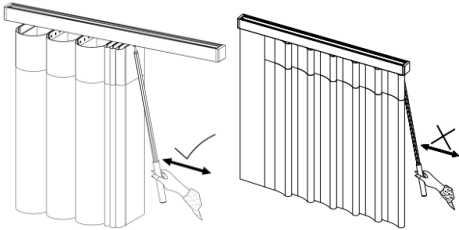

- If the fabric vanes don't move simultaneously when rotating the wand, please keep rotating the wand to one end until you hear the "click-click" sound and then rotate the opposite direction to another end until you hear the click sound again. See if it's back to normal.

